

**AMERICAN HERDING BREED ASSOCIATION TRIALS and TESTS**  
**Sponsored by Pikes Peak Herding Association**

ENTRIES OPEN – March 1<sup>st</sup>, 2026.  
ANY ENTRIES RECEIVED PRIOR TO 3/1/26 WILL BE HELD UNTIL THAT DAY  
Entries will be processed by random draw each day

**ENTRIES CLOSE – May 8<sup>th</sup>, 2026 at 5:00 pm**



Saturday

May 23<sup>th</sup>, 2026

Location: **Hachita Farms, Elizabeth, Colorado**

**Saturday - Judge Terri Wilson**

Herding Trial (HRD) – Sheep  
and (HTAD) Ducks Course #2  
Junior Herding Dog (JHD) - Herding Capabilities Test (HCT)

**Saturday - Judge Terri Wilson**

Herding Trial (HTAD) – Sheep Course #2  
and (HTAD) Ducks Course #2

**Saturday - Judge Carrie Sparks**

Junior Herding Dog (JHD) - Herding Capabilities Test (HCT)

**LIMIT – 50 runs total**

Day of Entries accepted starting at 7:30 am (if runs are available)\*

\*You can call Trial Secretary for status 719-338-0065

**TRIAL SECRETARY – Sue Scott / Lindsey Scott**

**Champion Dog Events**

28485 Mid Jones Road

Calhan, CO. 80808

phone - (719) 338-0065 e-mail – [chdogevents@aol.com](mailto:chdogevents@aol.com)

[www.championdogevents.com](http://www.championdogevents.com)

**PLEASE REVIEW COURSE DESCRIPTIONS AT [www.ahba-herding.org](http://www.ahba-herding.org)**

**&**

**SEE INCLUDED HRD COURSE MAP ON NEXT PAGE**

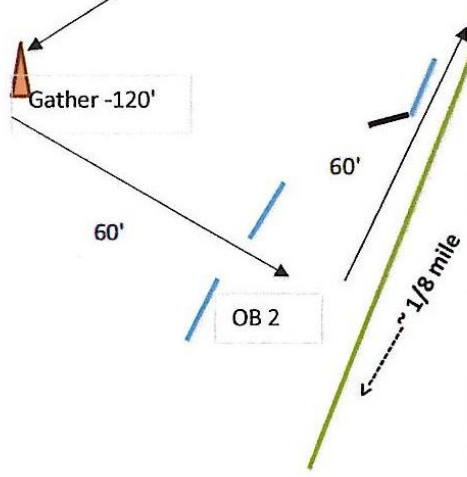
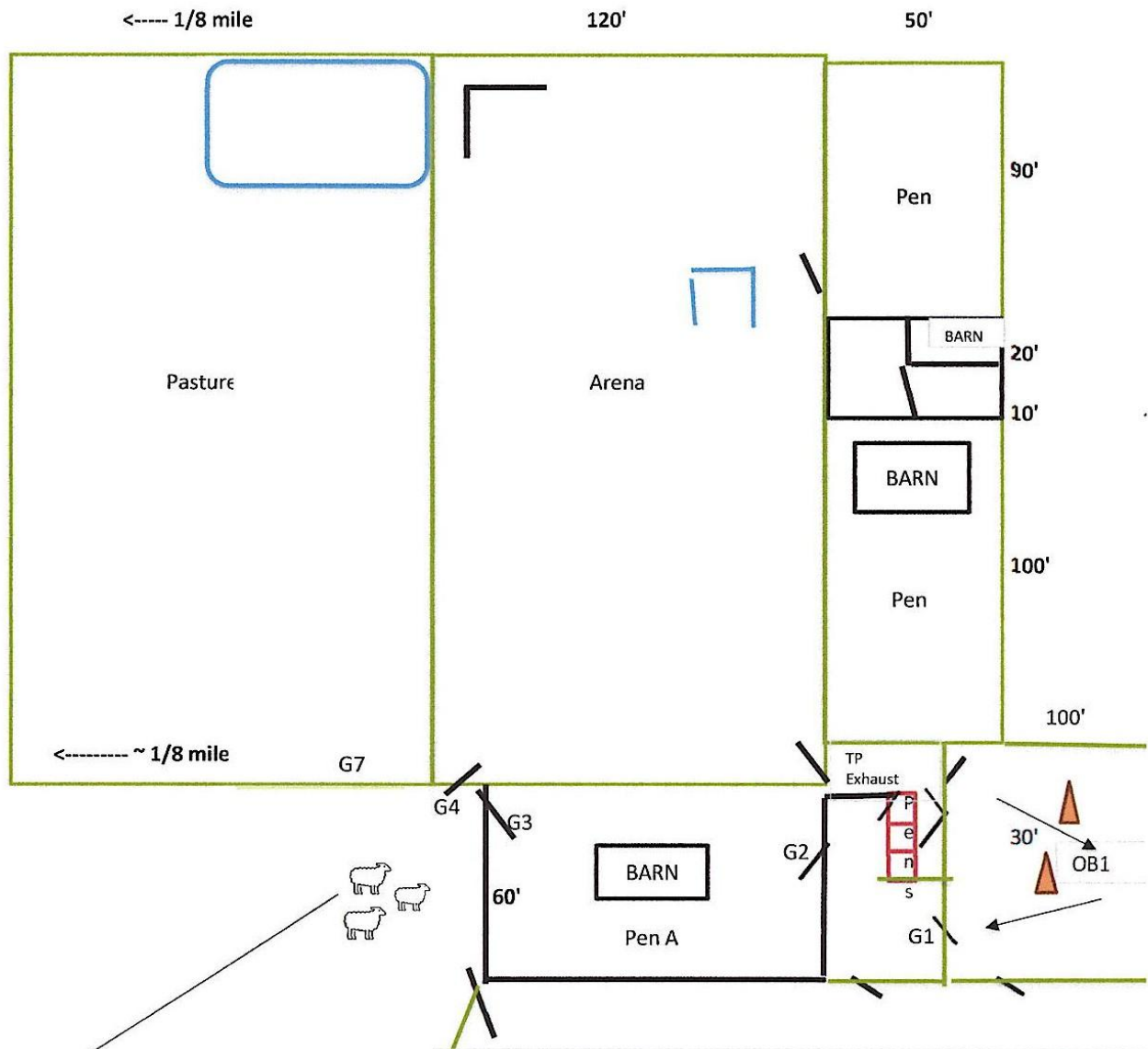

- HRD 5/23/26**
1. TP: III- must stay out of pen, II- may go inside gate, I-may go inside pen
  2. Sheep thru OB 1 to G1: III- drive, II- drive half, I- fetch/drive H may walk thru
  3. Thru G1 to G2: all levels
  4. Fetch/Drive thru Pen A to G3: all levels
  5. Set up for Gather/Gather to/around cone: III dog/H cone, II- dog at cone H 1/2way, I- Dog 1/2way, H no closer than 15' to sheep
  6. Fetch/drive thru OB2: III- H at cone, II- H halfway, I- H may not walk thru
  7. Fetch/Drive thru Y chute: III - remain at cone until sheep exit, II- may not cross plane of OB2 until sheep exit, I- may not go thru
  8. To/thru G4: all levels
  9. Exhaust-all levels must show hold off gate: III- off open gate, II- partially open, I closed gate.
- \*\*HRD III Additional\*\*** Gate sort 2 sheep before exhaust.

## ENTRIES

**Pre-entry (on or before 5/8/2026)**                      HRD/HTAD \$55                      JHD \$55                      HCT \$55  
Junior Handlers: ½ of listed Entry Fee  
**After 5/8/2026, including day of entries, add \$10.00 per run, if available**  
Make money orders or checks payable to Champion Dog Events, and mail to:  
*Champion Dog Events, 28485 Mid Jones Rd, Calhan, CO 80808*

Course Director: Carrie Sparks  
Stock Supervisors: Jennifer Hail and Dana Nelson

**Eligibility:** Trial is open to all breeds 9 months of age and older.

HCT dogs may be 6 months of age or older. All dogs must be sound and of good health.

**Sheep Count:** We will be using 5-6 sheep for HRD, 4-5 sheep for HTAD, 3 sheep for JHD and HCT.

**Ducks Count:** We will be using 5 ducks

**Stock replacement value per head: \$300 per sheep, \$100 per duck**

**Online Entries** at [www.championdogevents.com](http://www.championdogevents.com)

[Payment for online entries can be either Credit Card, PayPal or mailed check](#)

There is an additional fee of \$2.00 per entry for online entries.

Entry forms can be mailed and then followed up with PayPal payment to [chdogevents@aol.com](mailto:chdogevents@aol.com). Entries are considered accepted when entry form and payment are matched up – confirmation will be sent out as soon as that occurs.

Confirmation of Entry will be sent to the email address(s) on the Official entry form within 48 hours of receipt, if you do not receive email confirmation promptly please contact Trial secretary. Judging Schedule will be sent after close of entries.

CANADIAN EXHIBITORS MUST SUBMIT ENTRIES WITH CHECKS DRAWN ON U.S. ACCOUNTS OR WITH INTER-NATIONAL MONEY ORDERS IN U.S. FUNDS.

Entry fee will not be refunded in the event that a dog is absent, (unless replaced by an alternate), disqualified, excused by Veterinarian or Judge or barred from competition by action of the Trial Committee.

**Post Dated Checks & Returned Checks** do not constitute a valid entry fee. The Trial Secretary will add a \$25.00 collection fee to the amount of each returned check. Subsequent returned checks from the same exhibitors may result in their being put on a CASH ONLY basis.

**Ribbons and/or Dog Themed awards for:**

- High In Trial
- Reserve High In Trial
- Qualifying Score
- 1<sup>st</sup> – 4<sup>th</sup> place
- High Scoring Level I
- High Scoring Level II
- High Scoring Level III
- New Title Ribbons available

**Owners/handlers will be expected to clean up after their dogs. Dog walking area will be along the dirt road north of the white fence. A scoop and bags will be provided if needed.**

**Please be prepared with shade cloths, easy-ups, rain gear, sun screen etc.....weather can vary throughout the day. A bath/cool off tub will be provided.**

**CONCESSIONS**

Snacks and bottled water will be provided. Bring chairs and canopies for shade.

## PARKING AND LODGING

**RV PARKING:** Casey Jones RV, Elizabeth, CO 303-646-2346

**Onsite Lodging:** None

Holiday Inn Parker  
19308 Cottonwood Drive  
Parker, CO 80138  
877-411-3436

Super 8  
6230 E. Pine Lane  
Parker, CO 80138  
720-851-2644

## DIRECTIONS TO THE TRIAL SITE:

4500 Private Rd 162, Elizabeth, CO 80107  
(Second house on the left, white with black trim)

### From Castle Rock:

Take Hwy 86 through Franktown and through the town of Elizabeth. At the top of the hill--turn left/north on County Rd 21. Go north on CR 21 for 5.7 miles to Private Rd 162. Turn left/west on PR 162 (dirt road).

### From Castle Pines:

Take Hess Rd east --will turn into Hilltop ~1 mile after crossing Parker Road-- stay on for another 4-5 miles to Singing Hills (can only turn left/east). Stay on Singing Hills east for approx. 7 miles (past 2 four-way stops) to County Rd 21 (First right after the second four-way stop). Can only turn right/south at CR 21. Go 1 mile south to Private Rd 162. Turn right/west on PR 162 (dirt road).

### From Parker:

Parker Road/Hwy 83 to Hess Rd. Left/east on Hess Rd— will turn into Hilltop after about a mile--stay on for another 4-5 miles to Singing Hills (can only turn left/east again). Stay on Singing Hills east for approx. 7 miles (past 2 four-way stops) to County Rd 21 (First right after the second four-way stop). Right/south at CR 21. Go 1 mile south to Private Rd 162. Turn right/west on PR 162 (dirt road).

### From Colorado Springs:

(I-25) North to Castle Rock (Wilcox exit) North to Hwy 86. East on 86 through Franktown to Elizabeth. Continue through Elizabeth--look for County Rd 21 at the top of the hill on your way out of Elizabeth. Left (North) on CR 21 for 5.7 miles to Private Rd 162. Left (west) on Private Rd 162 (dirt road). You can also come up from Colorado Springs on Hwy 83 to Franktown, then turn right (west) on Hwy 86 to Elizabeth and continue. More scenic and usually less traffic.

### EMERGENCY ROOM

Parker Adventist Hospital  
9395 Crown Crest Blvd  
Parker, CO 80138  
303.269.4800

### URGENT CARE

20 Mile Urgent Care  
11355 S. Parker Road  
Parker, CO 80134  
720.974.7210

### VETERINARIAN

Animal Emergency and Specialty Center  
17701 Cottonwood Drive  
Parker, CO 80134  
720.842.5050

### Disaster and Emergency Plans for People and Dogs at this Herding Event

- **Fire:** Dial 911. All dogs should be crated or leashed securely. Owners, Handlers and Spectators must keep the main driveway clear so Emergency vehicles will have suitable access to the property.
- **Thunderstorms and Lightning:** Should lightning be observed, all people and dogs should move to the safety of their vehicles or covered buildings until the danger has passed.
- **Mass Disaster Plan – Tornado:** In the event of a tornado, dogs should be leashed and all people and their dogs should proceed to the lowest point on the property until the danger has passed.
- **Personal Injury or Health Problems:** Dial 911 for the Emergency Response Team/Ambulance, or see above.

## NOTICE TO EXHIBITORS

- ✓ A separate entry blank must be completed for each dog entered. Bitches in season will be permitted to run, but will be moved to the end of the running order. Please notify the Trial Secretary if your bitch is in season.
- ✓ Entry fees will be refunded to alternates who decline to be placed on the alternate list. Also, entry fees of alternates who do not participate in the trial will be refunded. Entry fees will not be refunded to a scheduled entrant who is absent on the day of the event unless an alternate is present and runs in the place of the absent dog.
- ✓ The Trial Secretary will void and destroy any and all checks to be refunded after the event. Checks will not be returned via mail.
- ✓ Entry fees will not be refunded in the event that a dog is absent, disqualified, excused or barred from competition by action of the Trial Committee/Judge.
- ✓ It is expressly understood that exhibitors alone are responsible for the behavior of their dogs and/or children. Any exhibitor whose dogs and/or children create unnecessary disturbances or repeatedly engage in unsafe or disruptive behavior may, at the discretion of the Trial Committee/Judge, be asked to leave the trial site. In such case, no refund of any fees paid will be made.
- ✓ Owners or their Agents are solely responsible for the presence of their dog(s) at the Trial arena. Judge is not required to wait for dogs.
- ✓ Exhibitors should follow their veterinarians' recommendations to assure their dogs are free of internal and external parasites, any communicable diseases, and have appropriate vaccinations.
- ✓ No entry fee will be refunded if the event cannot open or be completed by reason of riots, disturbances, fire, act of God, public emergency, act of a public enemy, extreme weather conditions, or any other cause beyond the control of the Trial Committee.
- ✓ No entry fee will be refunded in the case of duplicate entries or any other cause beyond the control of the club after the closing of entries.
- ✓ All dogs (except property owners dogs) must be **on leash** at all times except when in the Trial arena regardless of how well you think your dog is trained or behaved. Dogs not on leash will be asked to leave the trial site. In such case, no refund of any fees paid will be made.
- ✓ **Please respect the grounds and clean up after yourself and your dogs to maintain the premises in a clean and tidy condition!**

**Come join us for a great day!**



**ENTRY FORM – May 23<sup>th</sup>, 2026**

**Please fill out one entry form, per dog**

**Call Name:** \_\_\_\_\_

Registered Name: \_\_\_\_\_

Breed: \_\_\_\_\_ DOB: \_\_\_\_\_ Sex: \_\_\_\_\_

Registration # \_\_\_\_\_ Registry: \_\_\_\_\_

Breeder: \_\_\_\_\_

Sire: \_\_\_\_\_

Dam: \_\_\_\_\_

Owner: \_\_\_\_\_

Address: \_\_\_\_\_

City: \_\_\_\_\_ State: \_\_\_\_\_ Zip: \_\_\_\_\_

Phone: \_\_\_\_\_ Email: \_\_\_\_\_

Name of handler if other than owner: \_\_\_\_\_

*Circle Classes you are entering – SATURDAY – May 23, 2026*

Terri Wilson	Sheep HRD I	Sheep HRD II	Sheep HRD III	Ducks HTAD I	Ducks HTAD II	Ducks HTAD III
Terri Wilson	Sheep JHD	Sheep HCT				

Terri Wilson	Sheep HTAD I	Sheep HTAD II	Sheep HTAD III	Ducks HTAD I	Ducks HTAD II	Ducks HTAD III
Carrie Sparks	Sheep JHD	Sheep HCT				

Make check or money orders payable to: Champion Dog Events

Mail entries to: Champion Dog Events, 28485 Mid Jones Rd, Calhan, CO 80808

**Total Amount Enclosed \$** \_\_\_\_\_

In consideration for participation in an event sanctioned by the American Herding Breed Association (AHBA), I agree to assume all responsibility for any claim, loss, or damage, or whatever kind or nature, whether to person or property, which may be caused at or near this event, either directly or indirectly, by me or the dog or dogs I have entered in or brought to this event. I further agree that I will hold the AHBA, its officers, directors, agents and members; PPHA and its officers, directors, agents and members; and the property and stock owners and their agents, harmless and defend them from any and all liability for any injury, claim, damage or loss, of whatever kind or nature, whether to person property, caused at or near this event, whether directly or indirectly, by me or any dog I have entered in or brought to this event. I agree to indemnify the AHBA, its officers, directors, agents and members; PPHA ; and the property and stock owners, for any loss, cost or expense including attorney’s fees and costs, to which the AHBA, its officers, directors, agents or members, PPHA, or the property and stock owners, might be subject as a result of any claim, suit, loss or damage caused in any way by any act or negligence on my part or on the part of any dog or dogs I have entered in or brought to this event. I acknowledge that while the AHBA may provide sanctioning for this event with regard to the issuing of titles, it does not have and does not exercise control over the conduct of the event or those present. I certify and represent that the dog or dogs I have entered in or brought to this event is/ are not a hazard to other dogs, other animals, or to people.

Signature of entrant \_\_\_\_\_ Date \_\_\_\_\_