

**AHBA Trials**  
**October 19, 2025**  
**Magic's Legacy - W1192 Hwy B, Genoa City, WI**

**HRD SHEEP – All Levels**  
**2 Trials On Sunday only**

**Limited Entries - Open now, pre-entries close October 10<sup>th</sup>**

<b>JUDGES:</b>	Trial 1 - Nancy Hyser, Rockton IL Trial 2 - TBD
----------------	--

**FIRST HANDLER'S MEETING AT 8:00 AM**  
**JUDGING TO COMMENCE THEREAFTER**

**IMPORTANT INFORMATION**

<b>AHBA RULE:</b> Registration/tracking number is required for ALL dogs. This can be from any canine organization, or you can contact AHBA for a free number.		
<b>TRIAL RULES:</b> Trials are held in accordance with current AHBA rules posted at <a href="http://www.ahba-herding.org">www.ahba-herding.org</a> .		
<b>FARM RULES:</b> <ul style="list-style-type: none"><li>• All dogs must have current vaccination for rabies and other communicable diseases as recommended by your veterinarian, and should be parasite free.</li><li>• <b>PICK UP AFTER YOUR DOGS</b>... poop bags are available around the farm.</li><li>• All dogs must be on a leash or crated when not working.</li><li>• <b><u>NO FLEXI-TYPE LEASHES ARE ALLOWED ON THE FARM.</u></b> Please keep your dogs on a short leash at all times.</li><li>• Water pools are provided, but there is little or no shade, so plan accordingly.</li><li>• Handlers and spectators should keep their dogs at least 15 feet back from the fenced arena while a dog is working.</li></ul>		
<b>ENTRY FEE:</b>	\$45.00 \$50.00	ALL STOCK Day of Trial Entries – if available
<b>PRIZES:</b>	Ribbons for 1-3 Placements and AHBA Qualifying Ribbon for qualifying runs.	
<b>FOOD:</b> Upper Crust Pizzeria, N1070 Co Rd H, Lake Geneva (262) 279-2233 (Take Out or Delivery). McDonalds about 10 minutes away from the farm.		
<b>IF YOU HAVE ANY QUESTIONS, CONTACT THE TRIAL SECRETARY ... Catherine Price,</b> <a href="mailto:wolvescnp@yahoo.com">wolvescnp@yahoo.com</a> .		

HRD - STOCKTOBERFEST 2025  
Magic's Legacy, Genoa City WI  
2 Trials - October 19, 2025

10 sheep are placed loose in back field; no specific placement. Where the sheep are when the dog and handler go through the gate between the North Arena and the Back Field will determine the handler's first move.

If the sheep are somewhere out in the pasture, the handler will go to the first handler's post, send the dog and bring the sheep to the handler to begin the course. If the sheep are at the gate between the Back Field and the North Arena, that is where the sheep are gathered from.

1. Gather the sheep from wherever they are in the Back Field and take them back to the handler's post (cone #1). Level 3 handlers stay at the post, level 2 handlers may stand half way to the sheep, providing sheep are at least 75 feet away. Level 1 handlers may go to within 20 feet of the sheep
2. Take sheep in a straight line from the handlers post to obstacle #1, large free standing pen. Level 3 handlers must drive from the post; handler may leave post when sheep reach Cone #2 until handler gets in position to have the dog pen the sheep. Handler may leave the post when sheep reach Cone #2. Level 2 handler may walk behind their dog on the drive, and leave their sheep at Cone #2 while. They position themselves to pen the sheep. Level 1 handlers may wear the sheep to Cone #2, leave their sheep at Cone #2 with the dog until they are in position to pen their sheep. In all cases, at least 8 sheep must be penned before going on. Points deducted for sheep circling pen and for sheep left outside of the pen.
3. Dog and/or handler must take sheep out of the pen and take them to obstacle #2. Sheep must go around the right side of first panel, and in between the the second two panels. Level 3 handlers must stay at pen and drive through obstacle 2. Level 2 handlers may wear/dive to cone #3. At cone #3 the handler must stop and push the sheep the correct way through the p panel. Level 1 handlers may walk through the obstacle. Points deducted for sheep missing panels or going the wrong directions through panels.
4. Sheep must exit obstacle 2 left (South) and follow the "road" between the cones back to Cone #1. Level 3 handlers must remain at free standing pen until all sheep are at cone #1. Dog must hold sheep at Cone #1 until handler joins them and takes the sheep back through the gates into the North Arena. Level 2 handlers may walk around the outside of the cones on the "road" until all sheep are at cone #1. Level 1 handlers may wear the sheep down the road to Cone #1 and then on to letting sheep back into the North Arena.

5. Take sheep through North Arena through the gates into the Big Field, close gates behind sheep in both fields. Points deducted for sheep not going directly from Back Field gate through Big Field gate.

6. Handler and dog take sheep cross field to Alley Sorting Chute. All handlers put sheep into entry of alley sorting chute. Level 3 handler must let 5 sheep through each of the side and none through the end. Level 2 handlers must have at least 5 sheep out through either or both of the side chutes, and the rest an leave through the end. Level 1 should put sheep straight through the chute. For Level 1 points deducted for any sheep going out through side chute

7. Take all sheep over bridge and pen all sheep in Maple Arena. Sheep may not charge gate and through through quietly

## BACK FIELD MAP



Back Field Map

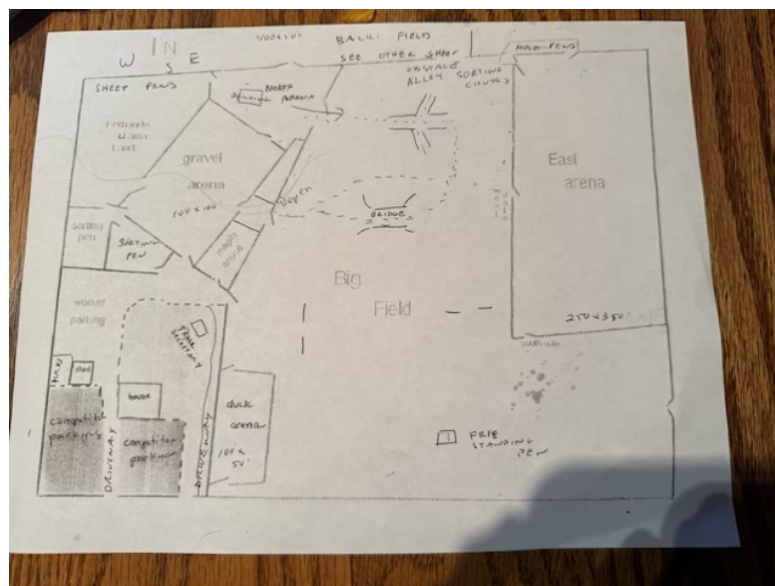

Big Field Field Map

# ENTRY FORM

Magic's Legacy

AHBA Tests/Trials

October 19, 2022

Pre-entries are \$45/class, Day of Trial entries (if available) are \$50.

Fee enclosed: \$ \_\_\_\_\_

**Make checks payable to MAGIC'S LEGACY.** Mail completed entry form and signed Agreement with fees to Event Secretary Catherine Price, W227 S10660 River Ave, Big Bend WI 53103. **Notification will be sent if you did not get into the trials.**

**LIVESTOCK – St.Croix/Cross sheep value \$250. Any livestock seriously injured while being worked must be paid for by the participant working stock at that time.**

DAY	CLASS	LEVEL	STOCK
<input type="checkbox"/> TRIAL 1	HRD	I II III	Sheep
<input type="checkbox"/> TRIAL 2	HRD	I II III	Sheep

Breed \_\_\_\_\_

Registered Name (Please use the same name for all AHBA Entries)

Reg. Number/Tracking Number (please use the same number for all AHBA Entries)

**NOTE: NO ENTRY CAN BE ACCEPTED WITHOUT EITHER A REGISTRATION NUMBER (i.e. AKC, ABCA, ASCA), OR AN AHBA TRACKING NUMBER.** An AHBA Tracking Number can be obtained by completing the request form on the AHBA website, and mailing it in. <http://www.ahba-herding.org/>.

Call Name \_\_\_\_\_ Sex \_\_\_\_\_ Birthdate \_\_\_\_\_

Name of Breeder \_\_\_\_\_

Name of Owner \_\_\_\_\_

Address \_\_\_\_\_

Name of Handler \_\_\_\_\_

Phone # (\_\_\_\_\_) \_\_\_\_\_ E-mail \_\_\_\_\_

**THIS MUST BE SIGNED BEFORE ENTRY CAN BE ACCEPTED.**  
**Entry Agreement and Indemnity**

The person who signs this Entry represents that she/he is authorized to enter into this Agreement and Indemnity on behalf of both the Handler and Owner of the entered dog in consideration of acceptance of this entry.

Handler and Owner whether or not members of American Herding Breed Association ("AHBA") agrees to abide by the rules and regulations of AHBA and all other rules and/or regulations shown in the premium list for this event.

Handler and Owner certify that the entered dog is not a hazard to persons, dogs or property. In the event the entered dog injures any livestock, the owner will pay for veterinarian services. If the injury is severe, the owner will pay the market value or value stated in the premium list of the stock injured.

Handler and Owner acknowledge that herding events are inherently dangerous and have risks of injury to persons. Handler and Owner agree to assume the risk of any harm arising from the hazards associated with the herding event which include but are not limited to, parking areas, ground conditions, animals, stock used in the herding event, and other dogs.

Handler and Owner hereby release AHBA, its officers, directors agents and members, including Shannon Wolfe, Magic's Legacy (its officers, agents and directors) and the owners of the site of the event, from any and all liability for any injury, loss or damage, of whatever kind or nature, whether to person or property which occurs directly or indirectly or associated with the herding event.

Handler and Owner agrees to indemnify and hold harmless AHBA, its officers, directors agents and members, including Shannon Wolfe, Magic's Legacy (its officers, agents and directors) and the owners of the site of the event, from any and all claims, loss or expense, including attorney's fees, arising out of any injury, loss or damage, of whatever kind or nature, whether to person or property which occurs directly or indirectly or associated with acts or failure to act of Handler or Owner, or any of the dogs entered in the herding event or brought to the site of the herding event.

---

Signature of Entrant

---

Date