



# **St. Paddy's Day Trial**

## **AHBA Herding Ranch Dog sheep HRDs**

### **PackLeader Farm**

**March 14, 2025**

14401 Crews Road NW  
Gig Harbor, WA 98329

**Judge:  
Linda Bell**

### **MacDonald's Ewesful Acres**

**March 15, 2025**

3710 Reeves RD SW  
Long branch, WA 98351

**Judge:  
Marti Parrish**

### **Frog's Breath Farm**

**March 16, 2025**

119 Reinseth Road  
Winlock, WA 98596

**Judge:  
Rebecca Lohse**

#### **2025 AHBA Trial Schedule:**

Hearts & Flowers  
February 14 – 16

St. Patrick's Day  
March 14 – 16

Ranch Large Flock  
July 12 – 14

Kelpie Round-Up  
July 18 – 20

Halloween Goblin & Ghouls  
October 24 – 26

Thanksgiving for Herding  
November 21 – 23



### Information and Entry Forms:

Barbara (253) 732-5959  
k9sayno@aol.com

Elsie (360) 785-0831  
elrhodes2@msn.com

### Classes

Herding Ranch Dog classes offered: HRDIs HRDIIs, HRDIIs

### Entry Fees & Entries

Pre-entries received on or before 3/8/2024

HRD 25 runs per day.....	\$55.00
Post Entries (received on or after 3/7/25 – if runs are still available) .....	\$60.00

**Dogs entered in all three trials have entry priority until 3/1/24.**

Send pre-entries and make money orders or checks payable to:  
Elsie Rhodes, 119 Reinseth Rd. Winlock, WA 98596-9326

### Trial – 25 runs per day

### Places & Awards

1<sup>st</sup> – 4<sup>th</sup> place ..... **Flats or Rosettes** (only if requested by the competitor)  
Each Day: High in Trial, Reserve High in Trial  
High Combined for the weekend

### Food

Each farm will supply lunch for contestants.

### The Very Special “Crook the Dog” Award Donated and sponsored by Kent and Darcy Bradley

This award is for HRD level I dogs that have not won it in the past. All scores for all three days are used. The highest combined score will be awarded a certificate, a crook in honor of Crook, and \$300.00. A special “Thank you” to Kent and Darcy for annually sponsoring this award.

**PackLeader Farm:** Telephone 253-732-5959

Address: 14401 Crews Road NW, Gig Harbor, WA

**From Tacoma and Seattle:**

- Hwy 16, Exit for Purdy/Key Center/Shelton, Hwy 302 W.
- (There are clearly marked signs leading to HWY 302 W. in several places along the way)
- Travel into Purdy, turn west at the light onto
- Hwy 302 W, go over the Wauna Bridge, travel 5.1 miles, turn RIGHT onto
- Hwy 302 W, Elgin Clifton Rd NW, toward Shelton/Allyn, travel 1.2 miles, turn RIGHT onto
- 150<sup>th</sup>, travel .1 miles (end of chain link fence) turn LEFT onto Crews Rd-1st Road into,
- Rocky Creek Conservation Area. Follow road approximately .8 mile through park.
- This road takes you through a green farm gate with a sign indicating PackLeader Farm.
- House is a two-story grey w/black trim.

**Motels & Camping**

Westwynd Motel – Apartments	6703 - 144 <sup>th</sup> St. NW., Gig Harbor	(800) 468-9963
Best Western Wesley Inn	6575 Kimball Drive, Gig Harbor (Purdy)	(800) 462-0002
The Inn at Gig Harbor	3211 56 <sup>th</sup> St. N.W., Gig Harbor	(800) 795-9980
Gig Harbor RV Resort	9515 Burnham Drive. NW, Gig Harbor	(800) 526-8311

RVs may park on site, no hookups

**MacDonald's Ewesful Acres:**

Telephone 253-370-0383

Address: 3710 Reeves RD SW, Longbranch, WA

**From Tacoma and Seattle:**

- Hwy 16, Exit for Purdy/Key Center/Shelton, Hwy 302 W.
- (There are clearly marked signs leading to HWY 302 W. in several places along the way)
- Travel into Purdy, turn west at the light onto
- Hwy 302 W, go over the Wauna Bridge, continue on 302 W straight onto
- Key Peninsula Hwy NW through Home, approximately 16 miles from Purdy, turn left onto
- 40th Street which curves then becomes Reeves. Turn left at
- The first driveway, it has a black mailbox 3710.

**Motels & Camping**

Westwynd Motel – Apartments	6703 - 144 <sup>th</sup> St. NW., Gig Harbor	(800) 468-9963
Best Western Wesley Inn	6575 Kimball Drive, Gig Harbor (Purdy)	(800) 462-0002
The Inn at Gig Harbor	3211 56 <sup>th</sup> St. N.W., Gig Harbor	(800) 795-9980
Gig Harbor RV Resort	9515 Burnham Drive. NW, Gig Harbor	(800) 526-8311

RVs may park on site, no hookups

**Frog's Breath Farm:**

Telephone: 360-785-0831

Address: 119 Reinseth Road, Winlock, WA

- Interstate 5 to Exit 63 Winlock/Toledo Hwy 505
- Turn WEST onto Hwy 505, toward Winlock, travel .05 mile to
- South Military Road, turn LEFT; travel 2.2 miles to
- Nikula Road, turn RIGHT; travel 1.5 mile to
- Reinseth Rd, turn RIGHT; second home on the LEFT. Green manufactured home.

**Motels & Camping**

Chehalis Inn (Off I5 at Exit 76)	220 Interstate Ave., Chehalis	(877) 740-5330 or (360) 740-5339
Best Western (Off I5 at Exit 76)	221 Interstate Ave. Chehalis	(360) 748-4040 or (800) 780-7234
Trout River RV Resort (Off I5 Exit 52)	150 Happy Trails, Castle Rock,	(360) 274-8373
Paradise Cove RV Park (Off I5 Exit 52)	112 Burma Rd, Castle Rock	(360) 274-6785

Limited, RVs may park on site, no hook-ups.



March 14, 15 & 16, 2025

Please fill out one entry form, per dog.

Call Name: \_\_\_\_\_

Reg. Name: \_\_\_\_\_

Breed: \_\_\_\_\_ Sex: \_\_\_\_\_ DOB: \_\_\_\_\_

Reg. #: \_\_\_\_\_ Registry: \_\_\_\_\_

Breeder: \_\_\_\_\_

Sire: \_\_\_\_\_

Dam: \_\_\_\_\_

Owner: \_\_\_\_\_

Address: \_\_\_\_\_

City \_\_\_\_\_ State: \_\_\_\_\_ Zip: \_\_\_\_\_

Phone: \_\_\_\_\_ Cell Phone: \_\_\_\_\_ E-Mail \_\_\_\_\_

Name of handler if other than owner: \_\_\_\_\_

Indicate Date/Farm and Level you are entering by marking the corresponding box.

	Friday 3/14/2025 PackLeader Farm	Saturday 3/15/2025 Ewesful Acres	Sunday 3/16/2025 Frog's Breath Farm
HRD I			
HRD II			
HRD III			

**Pre-entry fees (received on or before 3/7/25):** My entry will arrive **on or before 3/7/25** \_\_\_\_\_  
 HRD Sheep \$55.00

**Day of Entry fees (received on or after 3/7/25):** My entry will arrive **on or after 3/7/25** \_\_\_\_\_  
 Add \$5.00 per run to Pre-entry fees above, if runs are available.

Entry Total \$ \_\_\_\_\_

In consideration for participation in an event sanctioned by the American Herding Breed Association (AHBA), & hosted by Barbara Davenport, Sue MacDonald & Elsie Rhodes, I agree to assume all responsibility for any claim, loss or damage, of whatever kind or nature, whether to person or property, which may be caused at or near this event either directly or indirectly, by me or the dog or dogs I have entered in or brought to this event. I further agree that I will hold the AHBA, its officers, directors, agents, member, Barbara Davenport, Sue MacDonald & Elsie Rhodes, their families and employees harmless and defend them from any and all liability for an injury, claim, damage or loss, of whatever kind or nature, whether to person or property, caused at or near this event. I agree to indemnify the AHBA, its officers, directors, agents, members, Barbara Davenport, Sue MacDonald & Elsie Rhodes and their families and/or employees might be subject as a result of any claims, suit loss or damage caused in any way by any act or negligence on my part or on the part of any dog or dogs I have entered in or brought to this event. I acknowledge that while the AHBA may provide sanctioning and Barbara Davenport, Sue MacDonald & Elsie Rhodes are hosting for this event with regard to issuing of titles, they do not have and do not exercise control over the conduct, of the event or those present. I certify and represent that the dog or dogs I have entered in or brought to this event is/are not hazard to other dogs, other animal, or to people.

\_\_\_\_\_  
 Signature of owner / agent

\_\_\_\_\_  
 Date

**PackLeader Farm**  
**HRD – Sheep**  
**3-14-25**

**GENERAL RULES:**

- Time 25 minutes.
- In all elements, quiet efficient work is essential.
- All elements must be attempted prior to moving on.
- All gates may be open/closed or pre-set at the Handler's discretion to increase safety.
- Time will not end until all gates have been restored to their original/starting position.
- Ties are broken based on individual scores in the following order: Exercise 2 "Pens & Alleys", Exercise 5 "Obstacle #2", Time.

**STARTING SET- UP:**

- Sheep in Stockyard for Gather, sets of sheep in reserve pens.
  - The gate between Stockyard/Side Pen A, and P2/Arena A will be open at the beginning of each run
  - Stock handlers will be on course to manage the gates between Side Pen A/Stockyard and between Side Pen A/Narrow Alley.
1. **GATHER – 15 pts.:** Enter through the designated gate and move to the position appropriate for the team's level. Exercise begins when the dog is sent. Gather sheep and move them through the Stockyard, Side Pen A and into the Narrow Alley. Exercise ends when all sheep enter the Narrow Alley.
    - **HRDI** Dog may be positioned halfway to sheep, Handler may move to within 15' of sheep
    - **HRDII** Dog is positioned at the level III Handler's line. Handler may move to level II Handler's line.
    - **HRDIII** Handler remains behind the level III Handler's Line until the gather is complete.
  2. **PENS & ALLEYS – 20 pts.:** Exercise begins when sheep enter the Narrow Alley. Move sheep through the Narrow Alley and pen sheep in an empty pen in Alley C/D. Remove new group of sheep from the designated pen and move them through the Narrow Alley, P2 and into Arena A. Exercise ends when sheep are in Arena A.
  3. **FETCH/DRIVE – 15 pts.:** Exercise begins when all sheep enter Arena A. Move the sheep to the Fetch/Drive Marker. Fetch/drive sheep to the Final Drive Marker. Exercise ends when sheep pass the Final Drive Marker.
    - **HTADI** Handler may move anywhere.
    - **HTADII** Handler stays behind the Level II Marker until the sheep pass the Final Drive Marker.
    - **HTADIII** Handler stays behind the Fetch/Drive Marker until the sheep pass the Final Drive Marker.
  4. **OBSTACLE #1 – 10 pts.:** Exercise begins when sheep pass the Final Drive Marker. Move sheep through Obstacle #1 as drawn on diagram. Handlers may move anywhere but should not walk through the obstacle. Exercise ends when the sheep exit Obstacle #1.
  5. **OBSTACLE #2 – 10 pts.:** Exercise begins when the sheep exit Obstacle #1. Move sheep through Obstacle #2 as drawn on diagram. Exercise ends when sheep exit Obstacle #2.
  6. **OBSTACLE #3 – 10 pts.:** Exercise begins when sheep exit Obstacle #2. Move sheep through Obstacle #3 as shown on the diagram. Exercise ends when sheep exit Obstacle #3.
  7. **LEVEL III ONLY – Ribbon Pull - 10 pts.:** Exercise begins when the sheep exit Obstacle #3. Move the sheep to the Marker Cone as shown on the diagram. Remove ribbon from sheep. Exercise ends when the ribbon is removed.
  8. **REPEN – 10 pts.:** Exercise begins when sheep exit Obstacle #3 (levels I & II) or when the ribbon is removed (level III). Move sheep to the vicinity of P3, safely hold sheep off gate and release sheep into the stockyard through P3.

Exercise ends when gate is closed. Time stops when all gates returned to their original location.

# PACKLEADER

- ▲
- 
- 
- ▲

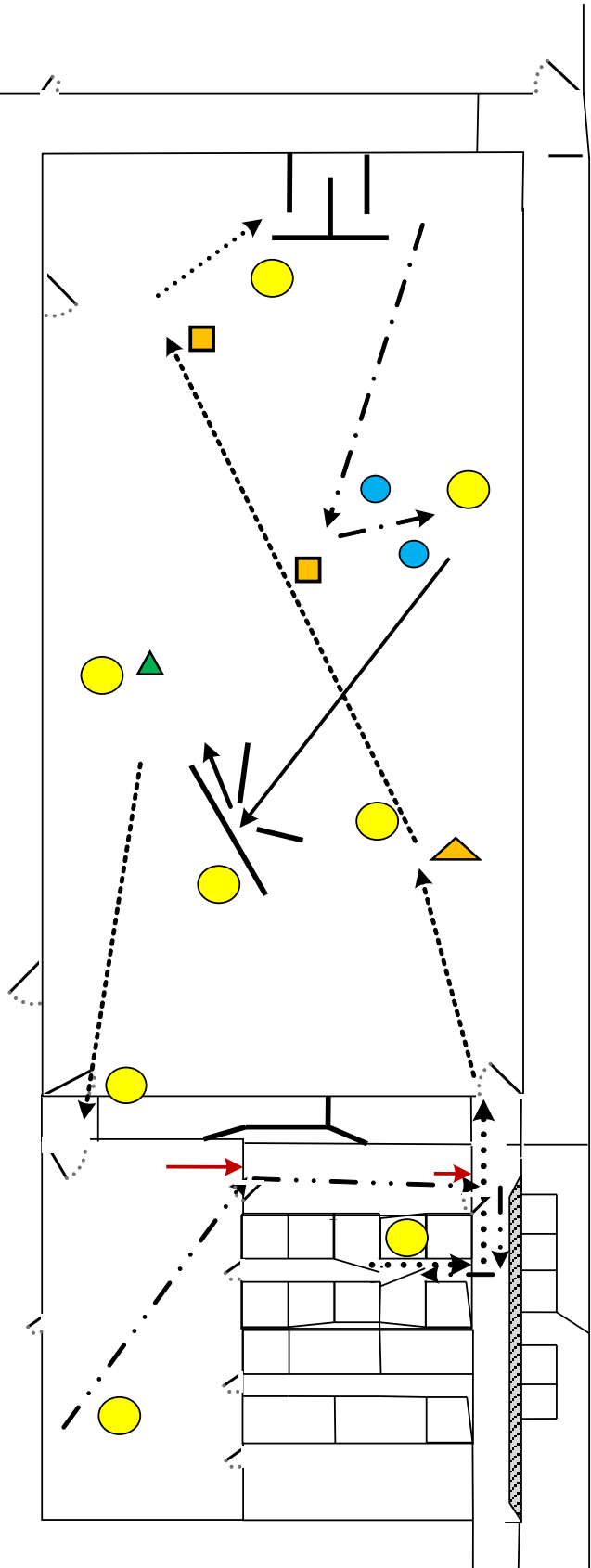

# MacDonald's Ewesful Acres

## HRD - Sheep

### 3-15-25

#### GENERAL RULES:

- Time 20 minutes.
- In all elements, quiet efficient stock work is essential.
- **Sheep will be safely held off ALL gates while gates are opened.**
- Time will not end until all gates have been restored to their original/starting position.
- Ties are broken based on individual scores in the following order: Exercise 3 "Obstacle #3/Trailer", Exercise 6 "Ribbon Pull", Time.

#### STARTING SET- UP:

- Sheep groups are located in Arena A pens, Field Pen (HRDIII Only), Round Pen, with additional groups of sheep in Barn Pens.
  - All gates will be closed at the beginning of each run. Both doors on the trailer will be open.
1. **OBSTACLE #1 - LEVEL III ONLY – 10 pts.:** Exercise begins when gate to the Field Pen is opened. Remove sheep from pen, negotiate Obstacle #1 as drawn on diagram and move to Arena A gate. Move sheep into Arena A and pen in empty Arena A Pen. Exercise ends when all sheep are penned in empty Arena A Pen.
  2. **OBSTACLE #2 – 15 pts.:** Exercise begins when gate to designated Arena A Pen is opened. Remove sheep from Pen and move sheep through Obstacle #2 as drawn on diagram. Handlers may move anywhere but should not walk through obstacle. Move sheep into Arena B. Exercise ends when all sheep enter Arena B.
  3. **OBSTACLE #3/TRAILER – 15 pts.:** Exercise begins when all sheep enter Arena B. Pen sheep in Barn Lean-to. Move to Round Pen and remove new group of sheep. Move sheep to Trailer and load through rear door and out the side door. Exercise ends when the sheep exit the Trailer.
  4. **FETCH/DRIVE – 20 pts.:** Exercise begins when the sheep exit the trailer. Open gate to Arena C. Move to Handler's Post. Fetch/drive sheep into Arena C to the Final Drive Marker. Exercise ends when stock have reached the Final Drive Marker.
    - **HRDI** Handler may move anywhere.
    - **HRDII** Handler stays at the half way Drive Marker while the dog drives the sheep to the Final Drive Marker.
    - **HRDIII** Handler remains at the Handler's Post while the dog drives sheep to the Drive Marker.
  5. **GATHER – 20 pts.:** Exercise begins when stock have reached the Final Drive Marker. Move to the position appropriate for the team's level. Recall dog. Gather stock and move them to the Handler's Post. Exercise ends when the sheep reach the Handler's Post.
    - **HRDI** Dog may be positioned halfway to stock, Handler may move to within 15' of stock.
    - **HRDII** Dog is positioned at the Handler's Post, Handler may move halfway to stock.
    - **HRDIII** Team will begin at the Handler's Post where the handler remains until the gather is complete.
  6. **RIBBON PULL – 10 pts.:** Exercise begins when sheep reach the Handler's Post. Close gate to Arena C. Remove ribbon from sheep. Move sheep to the Alley Gate. Exercise ends when the sheep enter the Alley.
  7. **REPEN – 10 pts.:** Exercise begins when the sheep have entered the Alley. Move sheep to the designated gate for the team's level and re-pen in the designated empty pen.
    - **HRDI & HRDII** Utilizing the gate to Arena A, move sheep to pen located in Arena A and pen sheep.
    - **HRDIII** Utilizing the gate to Field 1, move sheep to pen located in Field 1 and pen sheep.

Time stops when ALL gates have been restored to their original/starting position.

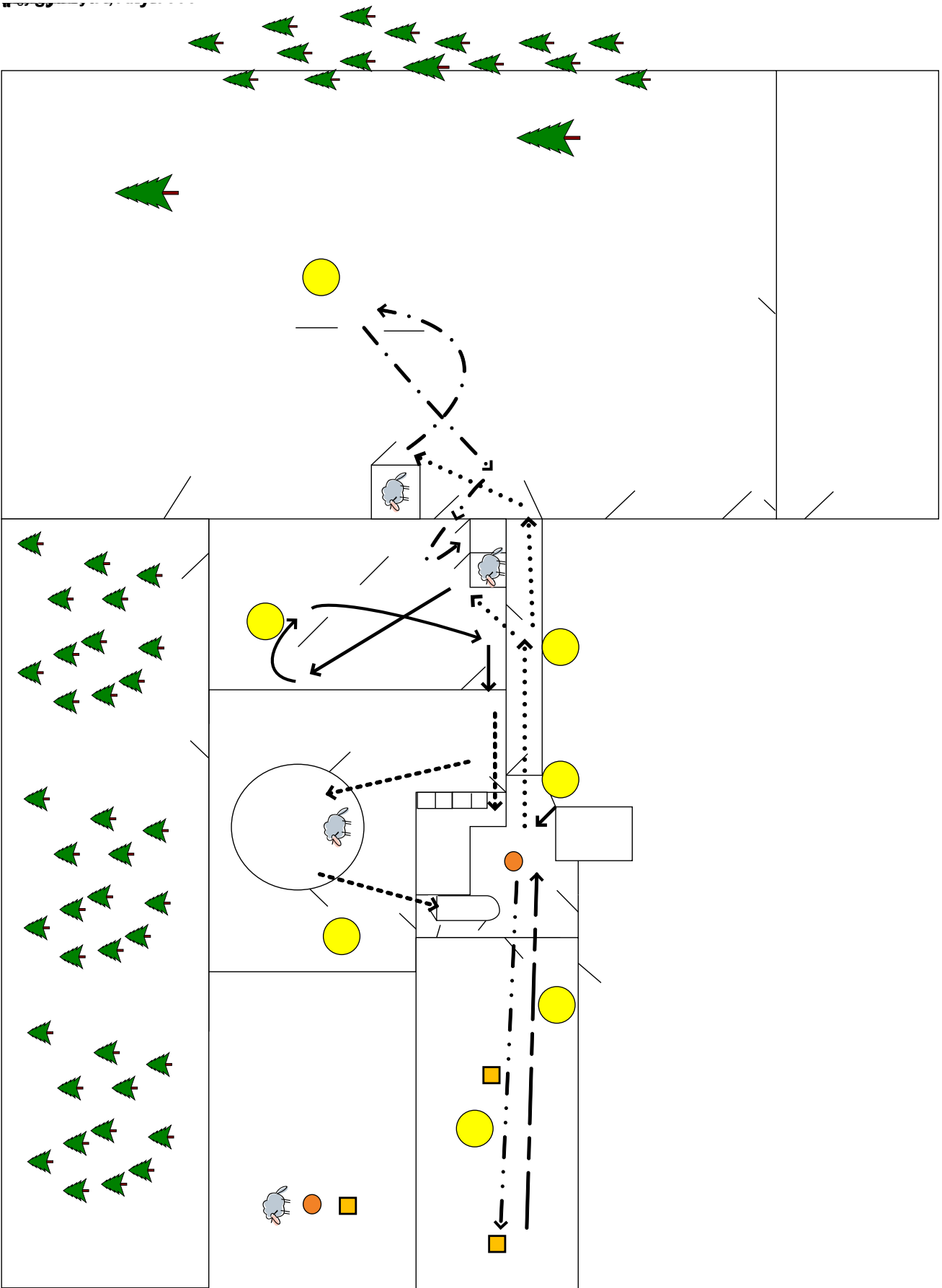

HRD - Sheep



# Frog's Breath Farm

## HRD- Sheep

### 3-16-25

#### GENERAL RULES:

- Time: 20 minutes.
  - All elements must be attempted prior to moving on.
  - Ties are broken based on individual scores in the following order: 1. Take Pen, Controlled Movement Obstacle #1, 5. Drive, Obstacle #2, time.
  - **STARTING SET-UP:**
    - There will be a set of (5) five sheep in Pen C.
    - All course gates will be in their original position of open or closed at the completion of the run.
1. **TAKE PEN, CONTROLLED MOVEMENT, OBSTACLE 1: 30 pts.** Time and exercise begin when the gate into Pen C is opened. Remove sheep from Pen. Move them through obstacle 1, on to the gate on the northwest end of Field 1a. Put the sheep into Field 1. Exercise ends when gate into Field 1a is closed.
  2. **CONTROLLED MOVMENT, PEN, HOLD: 10 pts.** Exercise begins when Field 1a gate is closed. Move the sheep to the lean-to penning them. The dog will hold the sheep under the lean-to while the handler puts a scoop of grain from the can into the feed pan. Exercise ends when the scoop has been replaced in the feed can and the lid put in place.
  3. **SETTLING SHEEP ON FEED: 5 pts.** Exercise begins when the lid is on the feed can. Remove the sheep from the lean-to, move to and settle the sheep at the feed pan. Exercise ends when the sheep are standing quietly at the feed pan.
  4. **OUTRUN, LIFT, FECTHS: 15 pts.** Exercise begins when the sheep are standing quietly at the feed pan. The dog is called off the stock and positioned at the post appropriate for its level. The dog is sent to gather the sheep, moving them to the HRDII & HRDIII Handlers Post, passing the post in a clockwise arch. The exercise ends when the sheep are behind the Handler's Post.
    - **HRDI** 75 ft. the dog is sent from the HRDI post. The handler may move to within 15 ft. of the sheep.
    - **HRDII** 150 ft. the dog is sent from the HRDII and HRDIII Post. The handler may move up the HRDI Handler's Post.
    - **HRDIII.** 150 ft. the handler and dog remain at the Handler's Post from which the dog is sent.
  5. **DRIVE, OBSTACLE 2: 20 pts.** Exercise begins when the sheep has past the Handler's Post. The sheep are driven/fetched to and through the two panels, then to the gate into Field 1a where they are held until the handler pens the sheep in Field 1a. The exercise ends when Field 1a gate is closed.
    - **HRDI** may move with the sheep, in any position, throughout this exercise except they may not pass through the panels opening.
    - **HRDII** must remain at the Handler's post until the sheep have passed through the panels or they have passed the panels. The handler may then move to the gate area.
    - **HRD III** will remain at the Handler's post while the sheep are driven through the panels and to the gate. The handler may move when the sheep are at the gate area.
  6. **CONTROLLED MOVEMENT, REPEN: HRDI & HRD II 10 pts.** The exercise will begin when the gate for Field 1a is closed. Move the sheep to the Repen area. The dog must hold the sheep off the gate while it is being opened. Pen the sheep. The exercise and time end when all the sheep are in the Repen and the gate is closed.
  7. **SORT HRD III only: 20 pts.** Gate sort two sheep into Pen B. One of those sheep must be painted. Repen the remaining three remaining sheep into Pen A. A hold off the gate is required as stated above. The exercise and time end when all the sheep are in the Repen and the gate is closed.

