

AHBA Trials Nov. 9th & 10th, 2024
Saturday & Sunday
HRD & HTD sheep, HTAD course 3 Sheep
HTAD Cattle, HTAD course 5 Ducks

Judges: Saturday 8am- Robin Reasoner
Sunday 8am – Melody Tillman Handler's meeting: 7:30am

Pre-entries must be postmarked by October 19, 2024

Entry fee: sheep \$40/day of \$45, Ducks \$35/day of \$40 Cattle \$50/\$55

Livestock: St.Croix/Dorper cross sheep, HTAD 4 head per run. HTD 3 head, HRD 5 head, cattle 3 head, Ducks minimum 4 head.

Trial is open to all herding breeds listed on the AHBA list.

- There must be an entry form for each dog.
- All entries **must** be accompanied by a signed & dated **Release Form**.
- Mail all entries with check made out to:

Melody Tillman email: tazmankennel@aol.com
8805 Brunswick Rd. Cell # 901-486-4372
Millington, TN 38053-4907 Please text

Entries will be taken in the order received until trial(s) are filled.

Awards: First through Fourth Place ribbons for each class.
Ribbons for all Qualifying scores.
HIT sheep each day.

Course Director: Melody Tillman
Stock Handlers: Andrea Hoffman, Melody Tillman

Lunch available \$5 donation per day

Veterinarians:

Animal Emergency Hospital
3767 Summer Ave.
Memphis, TN
901-323-4563

Notice to Exhibitors

- Please clean up after your dog(s) and yourself.
- Entry fee will not be refunded in the event that a dog is absent, disqualified, excused by a veterinarian or judge, or barred from competition by action of the Trial committee, or any other cause beyond the control of the Melody J Ranch.
- Dogs need to be present for scheduled judging. Judge need not wait for any dog holding up a class. Owners or agents alone are responsible for the presence of the dog in the arena.
- ALL DOGS MUST BE ON LEAD OR CRATED EXCEPT WHEN BEING JUDGED IN THE ARENA OR TRIALING AREA.
- There will be designated area (gates) for getting to arena during the trail.
- Pools and water buckets will be available for all dogs. **Do not** let dogs in sheep water tanks.
- Melody J Ranch, the AHBA, workers at the trial, owner of the site assume no responsibility for loss, damage, or injury sustained by spectators, exhibitors property and their dog(s) and further assume no responsibility for injury to children.
- Dogs may wear only plain buckle or snap-lock collar, or may work without a collar.

Directions:

- from I-40, Exit 24B, 385 toward Millington to Brunswick Rd. Turn right (north) go est. 4.5 miles on the left
- from Hwy. 14 take 385 toward I-40, turn left on Brunswick Rd. go est. 4.5 miles on the left.

•
Motels: Motel 6 (was Days Inn) I-40 Exit 20, Ph.#901-388-7120

NO PET FEE

Super 8 Motel, I-40 Exit 20, phone # 901-372-4575

Red Roof Inn, 6055 Shelby Oaks Dr. Mphs. #901-388-6111

No Pet Fee

Your responsibility to verify information.

MELODY J RANCH
Registration Form For AHBA Sanctioned Trial

NOTE: **ALL** information is needed. Write unknown if unknown.
If you do not have a Reg. Or Tracking #, you will need one.

Dogs Registered & 'call' name: _____
Registry and Number: _____
Breed: _____
Date of Birth: _____
Sire: _____
Dam: _____
Breeder: _____
Owner: _____
Address: _____

Phone: _____ E-mail: _____

HTAD Cattle Sat ___ Sun ___
HTAD ducks I, II, III Sat ___ Sun ___ HTD Sat ___ Sun ___
HTAD I, II, III Sat. ___ Sun ___ HRD I, II, III Sat ___ Sun ___

Entry form must be returned with the Release Form, signed & dated.

Any entries without the signed Release Form will not be accepted.

Pre-entry Postmark by: October 19, 2024

Entry fee: Sheep \$40/\$45 Cattle \$50/\$55 Ducks \$35/\$40

Make checks or money orders payable to: Melody Tillman

Send to: 8805 Brunswick Rd. Millington, TN 38053-4907

**Release Form for Herding Clinic(s), Trial(s)
and other herding activities during 2024
8805 Brunswick Rd. Millington, TN 38053-4907**

In consideration for participation in the Herding Clinic(s), Trial(s), and other activities held by Melody Tillman (Melody J Ranch), I (we) agree to hold Melody Tillman, her family and anyone associated with putting on these clinic(s), trial(s), and activities harmless from any claim for loss or injury which may be alleged to have been caused directly or indirectly to any person or thing by the negligence of any of the parties aforementioned, or by the negligence of any other person, or any other causes.

I (we) hereby assume the sole responsibility for and agree to indemnify and save the aforementioned parties harmless from any and all loss and expense (including legal fees) by reason of the liability imposed by law upon any of the aforementioned parties for damage because of bodily injuries, including death at any time resulting therefore, sustained by any person or persons, including myself (ourselves) or on account of damage to property, arising out of or in consequence of my (our) participation or any dog(s) I (we) have brought to this Herding Clinic(s), Trial(s), and other activities, however such injuries, death or damage to property may be caused, and whether or not the same may have been caused or may be alleged to have been caused by negligence of the aforementioned parties or any other person.

I (we) assume total responsibility and will pay for any livestock injuries or replacement value in the event or death of any livestock by my (our) dog(s). I (we) agree to pay \$20 for a duck, \$ for cattle, \$200.00 for sheep or \$100.00 for lambs in the case of serious injury, or the veterinarian bill if the injury is slight, whichever is agreed upon by the livestock owner.

Signature of Entrant: _____ **Date:** _____

Print name: _____

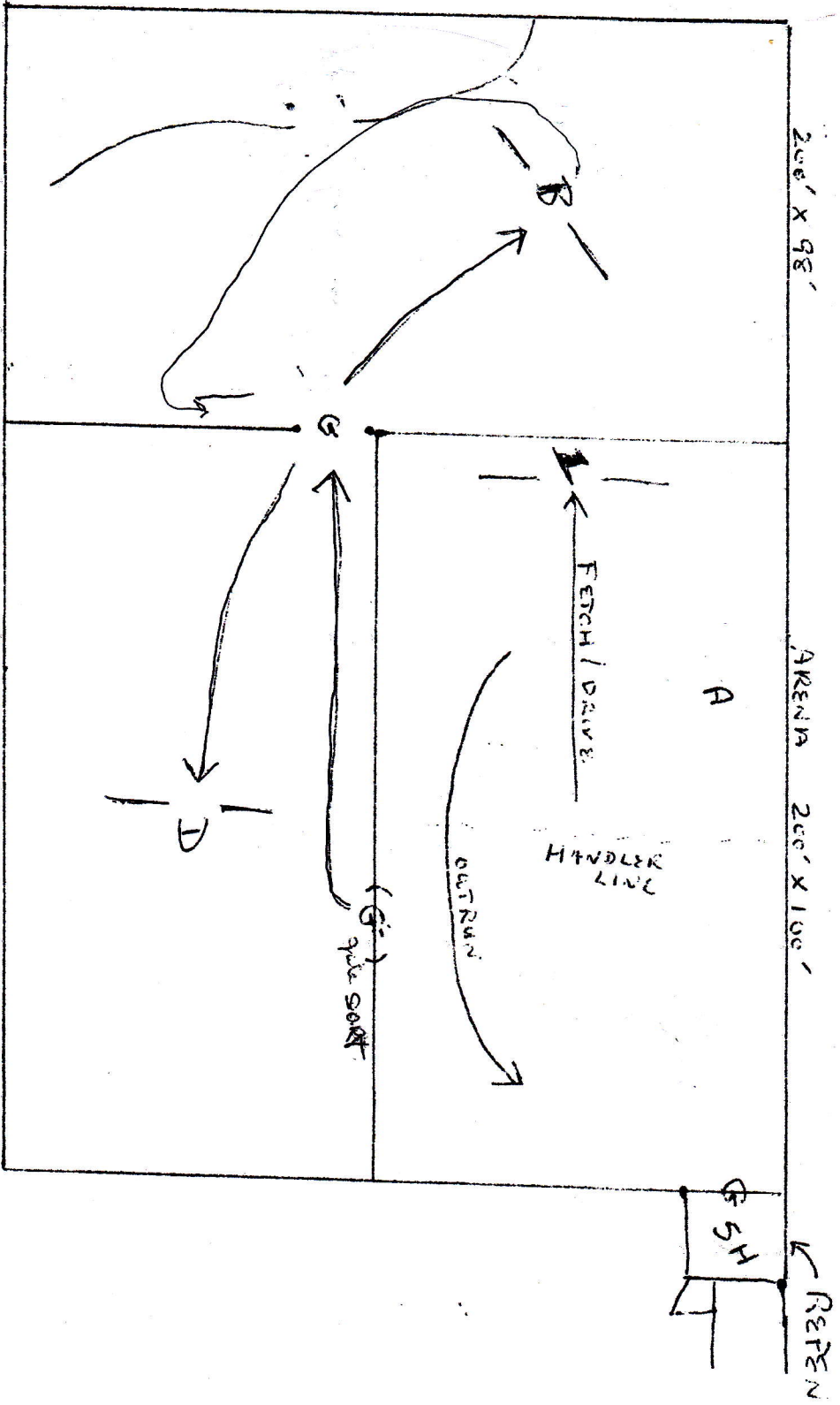

HRD 6-2024

BIRCH

MELODY J RANCH
HRD sheep

Note: There will be 5 head in the pen that will be dumped into the arena to start the run.

Outrun/Gather (15 points)

Level I the dog may be set halfway between the HP and stock. Handler may go within 15' of the stock.

Level II the dog must be set at the HP, the Handler may go halfway to the stock.

Level III the dog and Handler must stay at the HP.

Fetch/Drive/Panel (10 points)

Level I the Handler may fetch or drive the stock from cone thru Obstacle at end of the arena.

Level II the Handler must drive the stock from the cone thru Obstacle at the end of the arena.

Level III the Handler must drive the stock from the HP thru Obstacle at the end of the arena.

Level III only (10 points) will turn left after going thru panel, curve back to go thru panel A. After going thru panel A take stock clockwise around FS Pen and to the arena gate.

All Levels take the stock and put in Lot B. Then take to N. Lot and Obstacle B (15 points) Panel @ fence (15 points)

Stock need to be moved without running them. Closing gates behind you.

Once in N. Lot move stock thru Obstacle B, then around thru panel @ fence.

Bring back thru gate to Lot B closing the gate.

Obstacle D (15 points)

All levels move the stock thru the panels then return to arena.

Repen (10 points) Sort (10 points)

ALL levels will do a gate sort of 2 head, pause let the rest in arena, then go repen.

HRD6 2024 Tie Breaker: Panel B, Fetch/Drive, Score 15 Minutes

COURSE 5 DUCKS

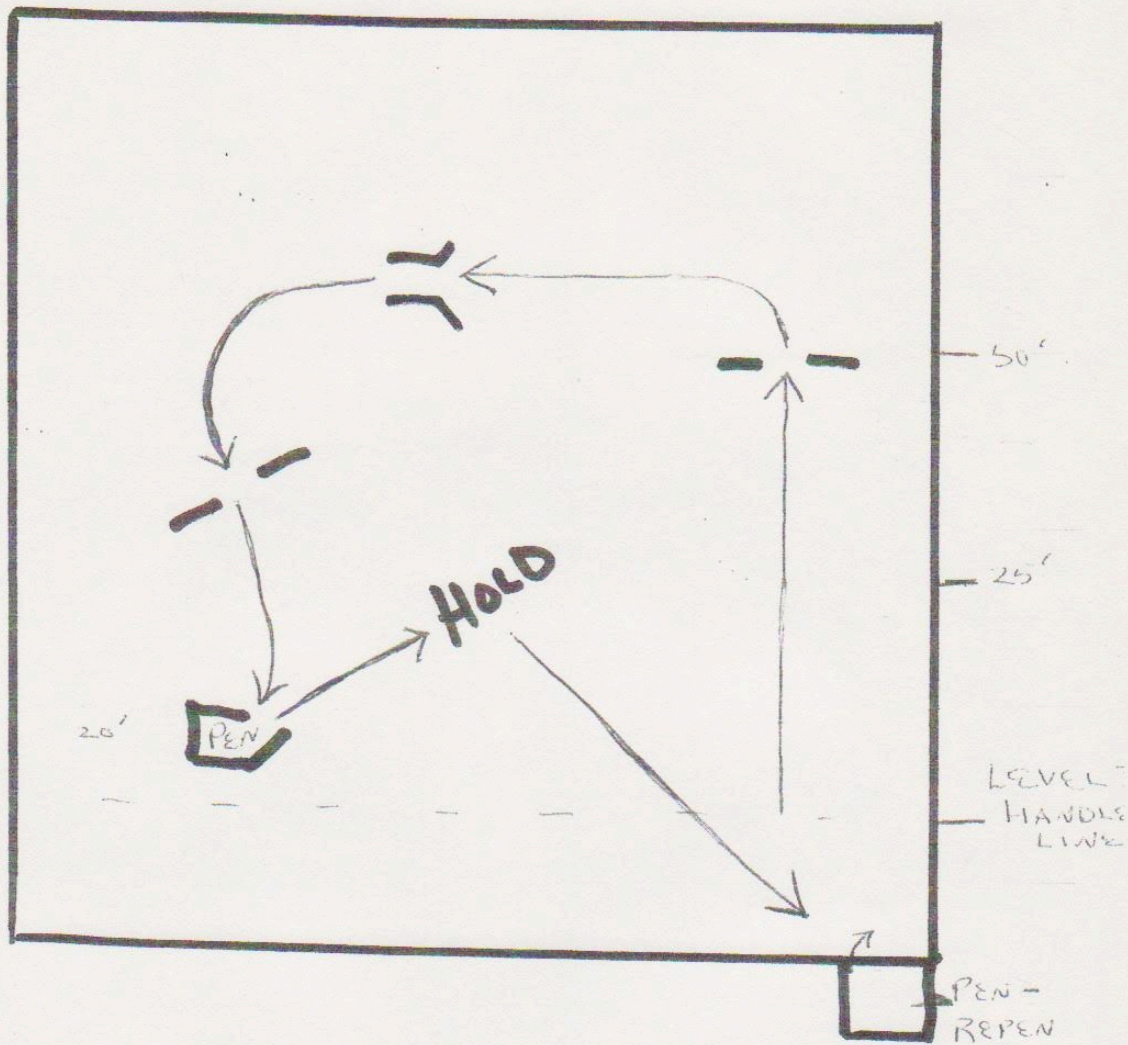

MELODY J RANCH
AHBA COURSE 5 DUCKS

Pen (10 points) All Levels will pull the ducks out of the pen.

Level I may go into the pen and help the dog if needed.

Level II may go into the pen and may not help the dog.

Level III may not go into the pen.

Fetch/Drive (15 points)

Level I may accompany the ducks to panel 1

Level II may accompany the ducks half the distance, then must drive the remainder of the distance.

Level III must drive the ducks to the panel from the HP.

Obstacle 1 (10 points) All Levels put the ducks thru the panels, then continue to Obstacle 2.

Obstacle 2 (10 points) All Levels put the ducks thru Obstacle 2, then continue to Obstacle 3.

Obstacle 3 (10 points) All Levels put the ducks thru Obstacle 3, then continue to Obstacle 4 (pen).

Obstacle 4 (15 points) freestanding pen. All Levels will pen the ducks. After the ducks have been penned, take them to the middle of arena for a Hold.

Hold (10 points) All Levels will do a Hold in the middle of the arena.

Repen (10 points) all Levels Gate sort Level III only (10 points)

Level I & II will repen the ducks.

Level III will sort 2 ducks, then repen the rest.