

**AHBA**  
**VALENTINES HERDING TRIAL**  
**sponsored by Florida Working Dog Club inc .**  
**and Black Birch Farm South**

FEBRUARY 14,15 2024 BLACK BIRCH FARM SOUTH 7551 SE  
181 CT MORRISTON FL 32668

JUDGES : SHERRY LEE FEB 14, DEB MINTZER FEB 15

HTD sheep with shed level III

HTAD sheep course 5 with gather and ribbon pull level III

HTAD ducks course 1 with a take pen, and shed level III

JHD-SHEEP

available runs. Sheep \$50 and ducks \$40

Course Director/Stock Supervisor- Diane Menard

Trial secretary -Bonnie Hansen

**PRE -ENTRIES OPEN Feb 01**

**Pre-entries postmarked before FEB 01 2024 will not be accepted. Entries must have clearly visible USPS postmark with the date. Pre-entries must be postmarked on/before close date of FEB 10 2024. No metered mail, telephone, facsimile, email or incomplete entries will be accepted. The entry limit per judge (40/day) will be accepted in postmark order. If a class is full the dog will be put on a waiting list in order of receipt. Day of Trial Entries (if available) accepted up to 30 minutes before trial start**

This trial shall be run under all AHBA rules and regulations. FMI: [www.ahba-herding.org](http://www.ahba-herding.org)

- Each individual is responsible for any damage caused by himself, his family or his dog while in the trial arena or on the trial grounds.
  - Livestock replacement costs are as follows: Ducks - \$20.00, sheep - \$300.00
- AHBA, Florida Working Dog Club Inc, Diane Menard and all trial workers assume no responsibility for any accident or injury.
- Ⓢ Bitches in season will run last. They should be crated away from trial arenas when not competing.
  - All dogs must be on leash when not competing.
  - Entry confirmation will be sent by email; please be sure to include your email address.
  - Trial committee will draw run order prior to the trial.
  - Entry fees will only be refunded if request is received on or before pre-entry closing date (**FEB 10**).

**AWARDS (including but not limited to)**

- Green ribbons for all qualifying runs
- placement ribbons or 1<sup>st</sup> place prize
- HIT prizes or rosettes

Dates of Event: WED AND THURS FEB 14,15- . Additional \$5.00 per class for entries or funds received after the closing date of SATURDAY FEB 10

**MAKE CHECKS OUT IN US FUNDS TO DIANE MENARD AND SEND TO TRIAL SECRETARY BONNIE HANSEN**

**SHEEP \$50 DUCKS \$40**

**Bonnie Hansen  
10993 124<sup>th</sup> ave  
Largo, FL 33778**

**ELIGIBILITY**

All dogs nine months of age or older are eligible to participate in Herding Trials and JHD. No dog may be entered in two classes on the same course with the same kind of stock under the same judge at any Test/Trial. Bitches in season shall run last.

**ENTRIES & FEES :**

- In the event that any dog is deemed absent prior to FEB 10,2024, its' trial slot(s) will be filled from the waiting list and any entry fee(s) will be refunded to the original entrant only, unless the original entrant provides a substitute dog. Substitutions will be allowed if the substitute dog is owned by the original entrant.
- Entry fees will not be refunded after FEB 10,2024 in the event a dog is absent, disqualified by a judge, or barred from competition by the trial committee. Entry fees will be refunded if excused in writing by a veterinarian.
- Entry fees will not be refunded if the trial cannot open or be completed by reason of riots, civil disturbances, fire and/or dangerous weather conditions, acts of God, public emergencies, acts of public enemy, strikes or other causes beyond the control of FLORIDA WORKING DOG CLUB INC.
- Selling runs is not permitted unless the trial is full. All offers to buy or sell runs must be submitted to the show secretary

⊙DIANE MENARD will deposit entry fees in our bank account on or about FEB 14,2024. Any checks returned for insufficient funds will be considered a void entry. There is a \$50 service charge for returned checks. If entries are resubmitted, payment must be in the form of cash, Money Order or Cashiers' Check.

**FOOD:**

BYO lunches & drinks. There is one place nearby for pizza and subs Pavarottis in Rainbow Springs 5 miles

In consideration for participation in an event sanctioned by the American Herding Breed Association (AHBA), I agree to assume all responsibility for any claim, loss or damage, of whatever kind or nature, whether to person or property, which may be caused at or near this event, either directly or indirectly, by me or the dog or dogs I have entered in or brought to this event. I further agree that I will hold the AHBA, its officers, directors, agents and members, Florida Working Dog club inc and Diane Menard harmless and defend them from any and all liability for any injury, claim, damage or loss, of whatever kind or nature, whether to person or property, caused at or near this event, whether directly or indirectly, by me or any dog I have entered in or brought to this event. I agree to indemnify the AHBA, its officers, directors, agents and members for any loss, cost or expense including attorneys' fees and costs, to which the AHBA, its officers, directors, agents or members might be subject as a result of any claim, suit, loss or damage caused in any way by any act or negligence on my part or on the part of any dog or dogs I have entered in or brought to this event. I acknowledge that while the AHBA may provide sanctioning for this event with regard to the issuing of titles, it does not have and does not exercise control over the conduct of the event or those present.

AMERICAN HERDING BREED ASSOCIATION

HERDING TRIAL ARENA DOG COURSE 5

1. GATHER-- You and your dog walk up to the cone in the far right of arena for the outrun, lift and fetch

HTAD III must send dog from there and remain there until the drive is completed

HTAD II must leave dog at the cone and may go halfway to the stock

HTAD I may leave dog half way to the stock and may walk to no closer than 15ft from stock

2. OBSTACLE 1 AND 2 Fetch the sheep around the cone counterclockwise and proceed to drive the panels (obstacle 1 and 2 )HTAD 3 must remain at the cone as the dog takes the livestock thru obstacle 1 and 2

HTAD 2 HANDLERS may accompany their dog and livestock to obstacle 1 and must stay there while driving thru obstacle 2. HTAD 1 HANDLERS may accompany their dogs while they drive or fetch thru obstacle 1 and 2

3. OBSTACLE 3-- the bridge, must be attempted with the handler inside the box level3, level 2 may not cross the center of the bridge until the livestock has passed over it. And Level 1 may drive or fetch from any position over the bridge.
4. OBSTACLE 4 --Drive or fetch to the Y chute. Level 3 must handle it from a boxed in area. Level 2 may not go by the center of the obstacle until the livestock clears it and Level 1 may drive or fetch the obstacle from any position.
5. HOLD—Level 3 must first do a hold until the livestock is still and then pull a ribbon off of 1 sheep.

Level 2 and 1 do a hold until the stock is settled and the judge has called a hold

6. Reopen all sheep TA DA

COURSE 5

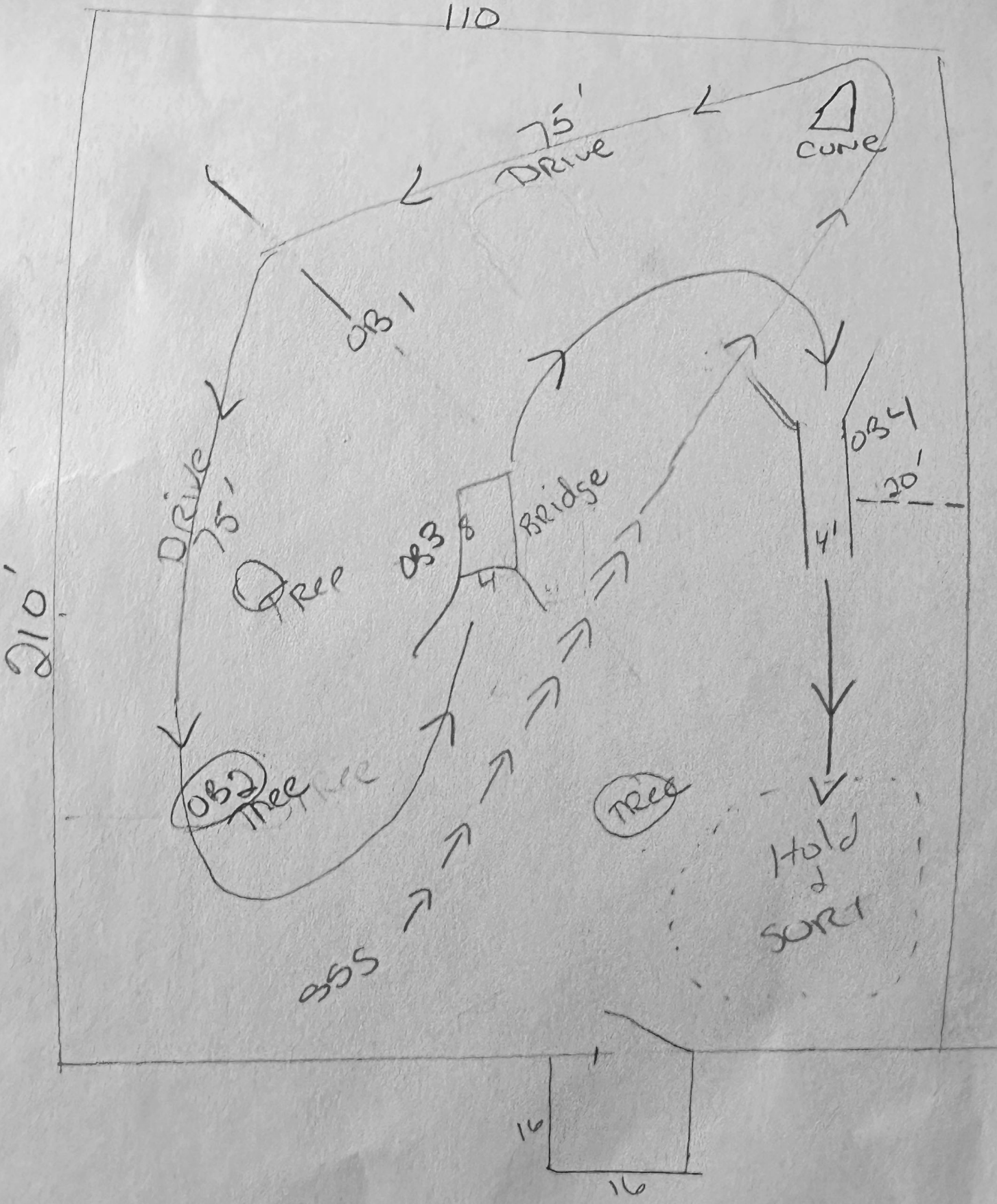

I CERTIFY and represent that the dog or dogs I have entered in or brought to this event is/are not a hazard to other dogs, other animals, or to people.

I CERTIFY that I am the actual owner of the dog or that I am the duly authorized agent of the actual owners whose name I have entered. In consideration of the acceptance of this entry, I (we) agree to abide by the Rules and Regulations of the AHBA in effect at the time of this Herding Test or Trial or both, and further agree to be bound by the agreement printed above. The entry is submitted on the foregoing representation and agreement.

Signature of Owner &/or Agent: \_\_\_\_\_

Please enter one dog per Entry Form. Please circle the trial and class and level you wish to enter.

WE RESERVE THE RIGHT TO REASSIGN JUDGES CLASSES DEPENDING ON ENTRY NUMBERS. IF YOU NEED A LEG UNDER A PARTICULAR JUDGE WE WILL ACCOMODATE YOU. AND THERE WILL BE OTHER AVAILABLE JUDGES IF NEEDED.

WEDNESDAY FEB 14 LEVEL					COURSE	
HTD	1	2	3	SHEEP	Fee: \$50	SHERRY LEE
HTAD	1	2	3	SHEEP	Fee: \$50	SHERRY LEE 5
HTAD	1	2	3	DUCKS	Fee: \$40	SHERRY LEE 1
JHD				SHEEP	Fee: \$50	SHERRY LEE

THURSDAY FEB 15 LEVEL						
HTD	1	2	3	SHEEP	Fee: \$50	DEB MINTZER
HTAD	1	2	3	SHEEP	Fee: \$50	DEB MINTZER 5
HTAD	1	2	3	DUCKS	Fee: \$40	DEB MINTZER 1
JHD				SHEEP	Fee: \$50	DEB MINTZER

**NOTE:** A dog must be entered in the name of the person(s) who actually owns it at the time entries are made for the Herding Test or Trial. A Registration and Registration number or Tracking Number must be included.

Actual owner(s):			
Address:			
City:	State:	Zip:	Country:
Telephone:		Email:	
Agent's name (if applicable):		Telephone (Agent only):	
Email (Agent only):			
Full name of Dog:			
Registration Number OR Tracking Number:		Registry:	Date of Birth:
Place of Birth	{ } USA	{ } Canada	{ } Other
Breed:	Variety:	Sex:	
Breeder:			
Call Name:			