

AMERICAN HERDING BREED ASSOCIATION TRIALS



Sponsored by Maple Grove Farm

1886 Bescher Chapel Rd  
Denton, NC 27239

**March 3-4, 2023**

**FRIDAY March 3, 2023**

AM Trial: Herding Trial Arena Dog Sheep  
Herding Trial Arena Dog Ducks

PM Trial: Herding Trial Arena Dog Sheep  
Herding Trial Arena Dog Ducks

**Judges: Cheryl Padgett and Kay Delk-Keziah**

**SATURDAY March 4, 2023**

AM Trial: Herding Ranch Dog Mixed  
Herding Ranch Dog Sheep

PM Trial: Herding Ranch Dog Mixed  
Herding Ranch Dog Sheep

**Judges: Cheryl Padgett and Kay Delk-Keziah**

HCT-s/JHD-s runs available both days pre entry only

Entry limits vary based on classes entered and stock available

**Trial starts 9:00am, first handlers meeting 8:30am**

**For more information: Kay Delk-Keziah, (336) 523-4161, maplegrovesfarm@yahoo.com**

**ENTRIES: Pre-entries must be received by Friday, February 24, 2023**

**FEES: HCT/JHD/HTAD-s,d/HRD-m,d - \$40.00/run**

There will be a \$40.00 service charge for any returned checks.

Same day entries will be accepted each day if available. Additional \$10.00/run.

Make checks payable to Kay Delk and mail along with completed entry form to:

Ilona Meeks  
590 Oak Grove Road  
Westminster, SC 29693

**ELIGIBILITY:** All dogs nine months of age or older are eligible to participate in Herding Trials and JHD. Dogs classified as Herding Dogs in AHBA are eligible for HERDING TEST (HCT) and may participate at six months of age or older. No dog may be entered in two classes on the same course with the same kind of stock under the same judge at any Test/Trial. Bitches in season shall run in drawn running order without adjustment.

**IMPORTANT. READ THIS BEFORE SIGNING RELEASE FORM**

In consideration for participation in the Herding Test/Trial held by MAPLE GROVE FARM, VIVIAN KAY DELK, LESTER A KEZIAH or THE DELK FAMILY I (we) agree to assume all responsibility for any claim, loss or damage, of whatever kind or nature, whether to person or property, which may be caused at or near the Herding Test/Trial, either directly or indirectly, by me or the dog or dogs I (we) have entered or brought to this Herding Test/Trial. I (we) further agree that I (we) will hold MAPLE GROVE FARM, VIVIAN KAY DELK, LESTER A KEZIAH or THE DELK FAMILY, AHBA, its Officers, Directors, Agents and Members; harmless and defend them from any and all liability for any injury, claim, damage or loss, of whatever kind, directly or indirectly, by me (us) or any dog I (we) have entered or brought to this Herding Test/Trial. I (we) agree to indemnify MAPLE GROVE FARM, VIVIAN KAY DELK, LESTER A KEZIAH or THE DELK FAMILY, the AHBA, its Officers, Directors, Agents and Members; for any loss, cost, or expenses, including attorney fees and costs, in which MAPLE GROVE FARM, VIVIAN KAY DELK, LESTER A KEZIAH or THE DELK FAMILY, the AHBA, its Officers, Directors, Agents and Members; might be subject to as a result of any claim, suit, loss or damage caused in any way by any act or negligence on my (our) part or on the part of any dog of dogs I (we) have entered or brought to the Herding Test/Trial. I(we) acknowledge that while MAPLE GROVE FARM, VIVIAN KAY DELK, LESTER A KEZIAH or THE DELK FAMILY, may provide for this Herding Test/Trial, it does not have and does not exercise control over the conduct of those present. I (we) certify and represent that the dog or dogs I (we) have entered or brought to this Herding Test/Trial is (are) not a hazard to other dogs, other animals, or to people. I (we) will pay for injuries or replacement value in the event of the death of any livestock by my (our) dog. If injury to any stock is caused by my (our) dog entered or brought to this Herding Test/Trial, I (we) assume full responsibility for any damage. I(we) agree to pay full market value of the injured animal in case of injury or the veterinary bill for the injury, whichever is agreed to by the Livestock Owner. I CERTIFY that I am the actual owner of the dog or that I am the duly authorized agent of the actual owners whose name I have entered. In consideration of the acceptance of this entry, I (we) agree to abide by the Rules and Regulations of the AHBA in effect at the time of this Herding Test or Trial or both, and further agree to be bound by the agreement printed above. The entry is submitted on the foregoing representation and agreement.

Signature of Owner &/or Agent:

(SEAL)

**NOTE: A dog must be entered in the name of the person(s) who actually owns it at the time entries are made for the Herding Test or Trial. A Registration and Registration number or Tracking Number must be included.**

Actual owner(s):			
Address:			
City:	State:	Zip:	Country:
Telephone:		Email:	
Agent's name (if applicable):		Telephone (Agent only):	
Email (Agent only):			
Full name of Dog:			
Registration Number OR Tracking Number:		Registry:	Date of Birth:
Place of Birth { } USA { } Canada { } Other			
Breed:	Variety:	Sex:	
Breeder:			
Call Name:			

Please enter one dog per Entry Form. **Please circle class and level you wish to enter.**

**Friday, March 3, 2023**

Judge: Kay Delk-Keziah	Class: HTAD Sheep	Level: 1 2 3	Fee: \$40
Judge: Cheryl Padgett	Class: HTAD Sheep	Level: 1 2 3	Fee: \$40
Judge: Kay Delk-Keziah	Class: HTAD Ducks	Level: 1 2 3	Fee: \$40
Judge: Cheryl Padgett	Class: HTAD Ducks	Level: 1 2 3	Fee: \$40
Judge: Kay Delk-Keziah	Class: JHD / HCT	N/A	Fee: \$40
Judge: Cheryl Padgett	Class: JHD / HCT	N/A	Fee: \$40

**Saturday, March 4, 2023**

Judge: Kay Delk-Keziah	Class: HRD Sheep	Level: 1 2 3	Fee: \$40
Judge: Cheryl Padgett	Class: HRD Sheep	Level: 1 2 3	Fee: \$40
Judge: Kay Delk-Keziah	Class: HRD Mixed	Level: 1 2 3	Fee: \$40
Judge: Cheryl Padgett	Class: HRD Mixed	Level: 1 2 3	Fee: \$40
Judge: Kay Delk-Keziah	Class: JHD / HCT	N/A	Fee: \$40
Judge: Cheryl Padgett	Class: JHD / HCT	N/A	Fee: \$40

**POLICIES:**

- This trial shall be run under all AHBA rules and regulations. FMI:  
[www.ahba-herding.org](http://www.ahba-herding.org)
- Use official AHBA entry form
- Everyone is responsible for any damage caused by himself, his family or his dog while in the trial arena or on the trial grounds.
- Livestock replacement costs are as follows: Sheep - \$400.00 Ducks - \$75  
\*AHBA, Maple Grove Farm, Vivian Kay Delk and all trial workers assume no responsibility for any accident or injury.
- Females in season will run last. They should be crated away from trial arenas when not competing.
- All dogs must be on leash when not competing.
- Entry confirmation will be sent by email; please be sure to include your email address.
- Trial committee will draw run order prior to the trial.
- Entry fees will only be refunded if request is received on or before pre-entry closing date (**February 24, 2023**).

**RIBBON PRIZE FOR EACH DAY**

Qualifying Score.....Dark Green  
HRD I, II, III.....Rosette 1st thru 4th Place  
HTAD I, II, III.....Rosette 1st thru 4th Place  
HIGH IN TRIAL .....Rosette and Tile  
Reserve HIGH IN TRIAL.....Rosette and Tile  
**PRIZES & AWARDS**

- First Place in all trial classes receives a fun award
- Qualifiers in Junior Herding Dog receives a Rosette
- High In Trial (each day) receives a herding themed award
- Reserve High In Trial Herding (each day) receives a herding themed award
- Special Golden Award for dogs ten years old and older. (Not an extra class, simply an award for the highest score achieved by a senior dog in any of the classes over the three days.

**Veterinarian:**

**Carolina Veterinary Specialists**

**1600 Hanes Mall Blvd, Winston Salem, NC**

**1-336-896-0902**

**Concessions:**

- Water will be available for people
- Water stations for dogs are scattered on facility site see Map.

**Lodging:**

HOTELS/MOTELS (please check pet policy before booking)

- COMFORT INN AND SUITES 1113 E Dixie Dr, Asheboro, NC 27203 (844) 209-0758
- QUALITY INN 901 Albemarle Rd, Asheboro, NC 27203 (336) 521-4848
- ECONOLODGE [825 W. Dixie Dr., Asheboro, NC, 27205.](#) (336) 493-4046
- MOTEL 6 827 Albemarle Rd Asheboro NC (877) 362-8688

**CAMPING**

- Maple Grove Farm Denton NC (call Kay for availability) (336)-523-4161
- Yogi Bear's Jellystone Park 964 Crestview Church Rd, Asheboro · (336) 964-0813

Please bring your yard chair and lunch dress for the weather!

We will practice the current FDA guidelines regarding COVID-19

Rules for trial participants will be given at course walk thru with judges.

Signed release forms will be required for everyone in attendance.

Please understand all of this is for everyone's safety

Thank you!

Maple Grove Farm

Duck Arena Course Map:

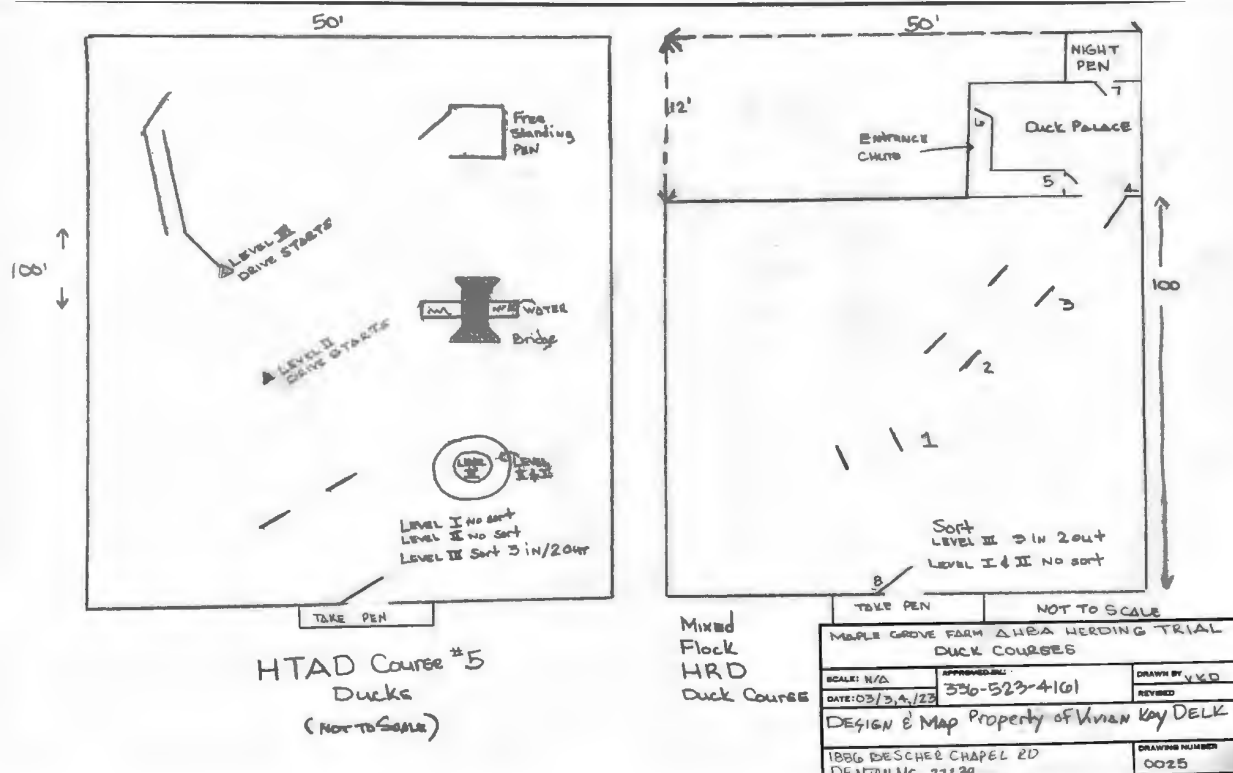

Sheep Arena Course Map:

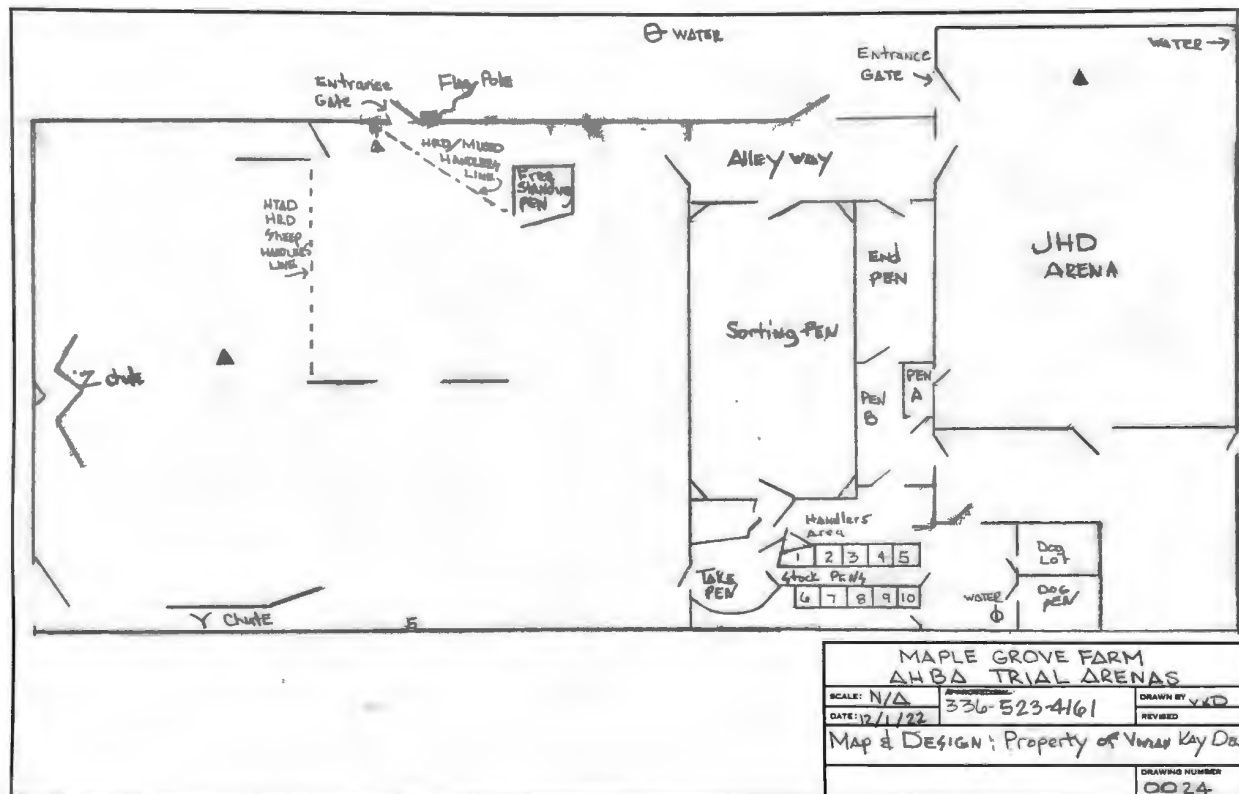

## Course Description - Herding Trial Arena Dog Ducks

**Time limit: 10 minutes**

1. **10 points** - ALL LEVELS Take ducks from take pen
2. Fetch or drive to ring and do a hold
  - a. **20 points** - Level III do a hold inside the inner ring
  - b. **15 points** - Level I & II do a hold inside the outer ring
3. **20 points** - Fetch or drive to bridge and cross over the water
4. **20 points** - ALL LEVELS Go to freestanding pen and pen
5. **15 points** - Fetch or drive through Y chute and through freestanding panels
  - a. Level III handler stays at end of Y chute and drives through panels
  - b. Level II handler can move to small cone then drive through panels
  - c. Level I fetch or drive through panels
6. Reopen in take pen
  - a. **15 points** - Level III gate sort 3 ducks in, pen last 2
  - b. **10 points** - Level I & II reopen all 5 together

## Course Description - Herding Trial Arena Dog Sheep

Time limit: 12 minutes

1. **5 points** - ALL LEVELS pickup 5 sheep from take pen
2. **15 points** - ALL LEVELS fetch or drive sheep to cone turning sheep counterclockwise around
  - a. Level II & III handlers stay at cone and drive from cone to the Y chute
  - b. Level I may fetch or drive to the Y chute
3. **10 points** - Take sheep from Y chute to corner 2 and through Z chute
  - a. Level III handler remains at the cone and drives sheep from Y chute to corner and through Z chute
  - b. Level II handlers can move as soon as stock leave Y chute and help as needed to fetch or drive to corner and through Z chute
  - c. Level I handlers may fetch or drive from Y chute to corner and through Z chute
4. **15 points** - From the Z chute, go to corner 3, turn stock and load in exam pen/panels
  - a. Level III handler remains at cone until stock has been driven to corner 3, then may move about as necessary
  - b. Level I & II fetch or drive through Z chute, to corner and through exam panels
5. **10 points** - Level III ONLY: Once sheep are in exam pen, handler moves to the gate while dog holds the open side, open the gate and bring stock through, close the gate with stock under control
6. **15 points** - ALL LEVELS fetch or drive from exam pen through free standing panels, handler may not cross through panels
7. **20 points** - ALL LEVELS Pen in free standing pen, take stock out and do a hold in area specified by judge
8. **10 points** - ALL LEVELS exhaust into alley (Gate A), and into end pen



## Course Description - Herding Ranch Dog Sheep

Time limit: 12 minutes

1. ALL LEVELS Start with 5 sheep in alleyway
  - a. **15 points** - Level III gate sorts 3 sheep into end pen (1 marked) and reunite all 5 in alleyway
  - b. **5 points** - Levels I & II take all 5 sheep into end pen and bring back out into alleyway
2. **10 points** - ALL LEVELS Bring stock through sorting pen through connecting alley into take pen
3. **10 points** - ALL LEVELS Bring stock into AKC arena under control and fetch or drive through Y chute
4. **10 points** - ALL LEVELS Take stock across arena into exam panel
5. **15 points** - Take stock from exam panel through free standing panels and to number 5
  - a. Level III drives from handlers line to number 5
  - b. Level II drives from handlers line through free standing panels
  - c. Level I fetch or drive to number 5, handler may not go through panels
6. **20 points** - ALL LEVELS Pen in freestanding pen then bring stock out of pen
7. **10 points** - ALL LEVELS Do a hold in area designated by judge
8. **10 points** - ALL LEVELS Reopen in take pen

\*\*\*Both HRD Course descriptions may be carried with handler through courses\*\*\*

**Course Description - Herding Ranch Dog Mixed Flock**  
**Time limit: 16 minutes**

**Sheep Half:**

1. **5 points** - ALL LEVELS Gather stock in duck arena to handler's post and around counter clockwise
2. **5 points** - ALL LEVELS Bring stock through side pen A into pen B (carefully watching and keeping stock under control)
3. ALL LEVELS Bring stock into end pen then into alleyway
  - a. **10 points** - Level III gate sorts 3 sheep (1 marked) into alleyway then reunite all in alleyway
  - b. **5 points** - Level I & II take all 5 sheep through end pen into alleyway
4. **10 points** - Take stock from number 4 to number 5
  - a. Level III must stay at handlers line and drive to number 5
  - b. Level II must stay at handlers line and drive through freestanding panels, then handler can move anywhere in the arena as necessary
  - c. Level I may fetch or drive to number 5, handler may not go through panels
5. **10 points** - ALL LEVELS Pen in freestanding pen
6. **5 points** - ALL LEVELS Bring sheep out of pen and do a hold in area specified by judge
7. **5 points** - Repen in take pen

**Duck Half:**

1. **10 points** - ALL LEVELS Take 5 ducks out of take pen & fetch or drive through panel 1
2. **10 points** - Take ducks through panel 2 and panel 3
  - a. Level III must stay at panel 1 and drive through 2 & 3
  - b. Level II may fetch or drive to panel 2, then drive through panel 3 while handler remains at panel 2
  - c. Level I may fetch or drive both panels, handler may not go through panels
3. **10 points** - ALL LEVELS Take ducks into duck palace and through chute, then into night pen
4. **10 points** - ALL LEVELS Bring ducks back into duck palace from night pen and into the duck arena and back through panel 1
5. Repen in take pen
  - a. **10 points** - Level III gate sort 3 ducks in, pen last 2
  - b. **5 points** - Level I & II repen all 5 together